

\* Applicable size of IC package : IC body size 14.0 x 20.0 mm  
IC outer size 17.6 x 23.6 mm

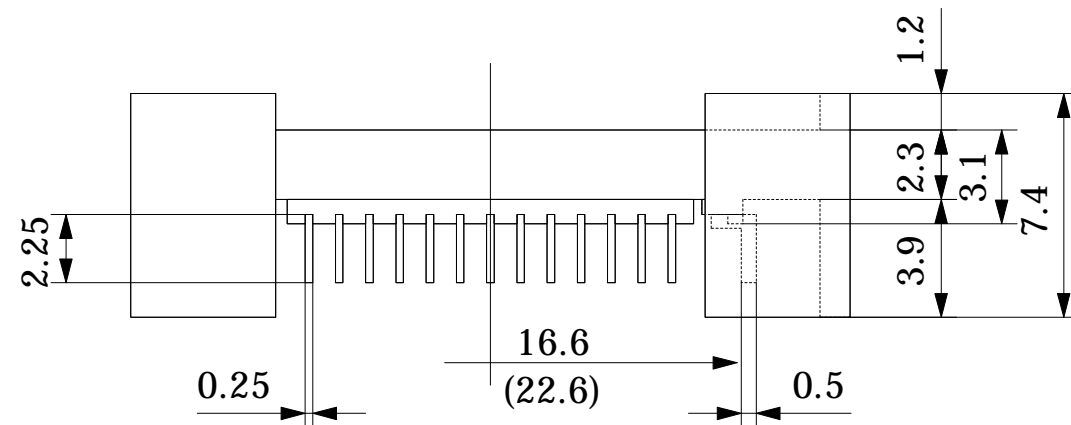

Part No.	<b>HQPACK064RZ</b>	
IC package	Rectangle	
Pin count	64Pin	
Lead pitch	1.0mm	
Unit : mm	Design : M.H	
<b>TET</b> TOKYO ELETECH CORP.		