

* Applicable size of IC package : IC body size 14.0 x 20.0 mm
 IC outer size 17.6 x 23.6 mm

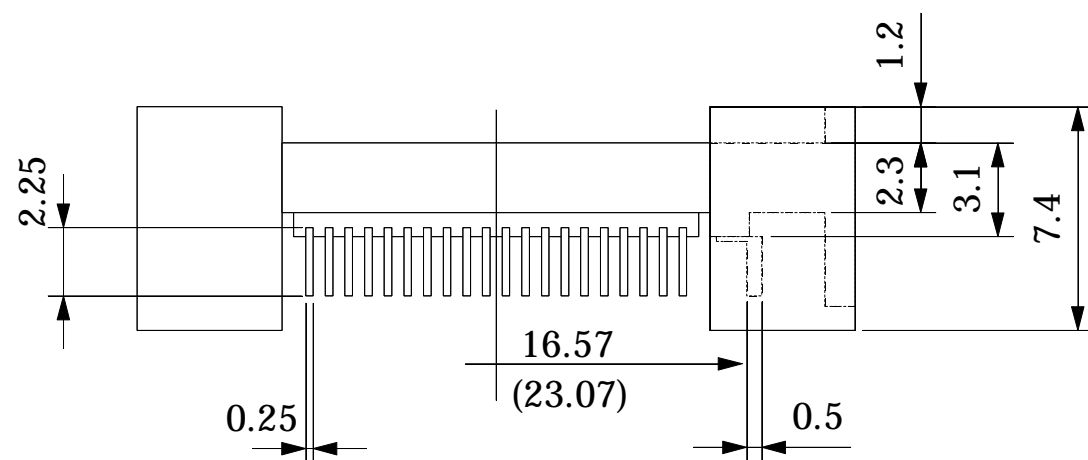

Part No.	HQPACK100RB	
IC package	Rectangle	
Pin count	100Pin	
Lead pitch	0.65mm	
Unit : mm	Design : M.H	
TET TOKYO ELETECH CORP.		